

6701 ODESSA AVENUE

VAN NUYS, CALIFORNIA

LOS ANGELES COUNTY



For Lease

Full Renovation Complete

15,232 SF

INSTITUTIONALLY OWNED & MANAGED | FLEXIBILITY TO EXPAND | DELIVERING UNPRECEDENTED CUSTOMER SERVICE

FOR INFORMATION, CONTACT:

RON FEDER
818-222-0404
rfeder@rjfeder.com
Cal DRE Lic #00983855

SEAN SEARS
818-466-6463
Seansears@peakcommercial.com
Cal DRE Lic #02182233

WAREHOUSE DISTRIBUTION

- Premiere Central Valley Location
- Newly Renovated
- 16'-18' Minimum Clearance
- 400 Amps Single Phase 3 Wire
- Two (2) Ground Level Loading Doors
- Fenced & Secured Rear Parking & Loading



**Rexford
Industrial**

PEAK
COMMERCIAL

6701 Odessa Ave. Van Nuys, CA - 15,232 SF

- \$1.85 PSF NNN
- \$0.22 PSF Estimated NNN
- Updated to Title 24
- Adjacent to Van Nuys Airport
- Convenient Access to 405 Freeway
- Enclosed Compressor/ Storage Room
- 36 Parking Spaces

Available Now

For Lease **15,232 SF**

6701 Odessa Ave. Van Nuys, CA



**Rexford
Industrial**

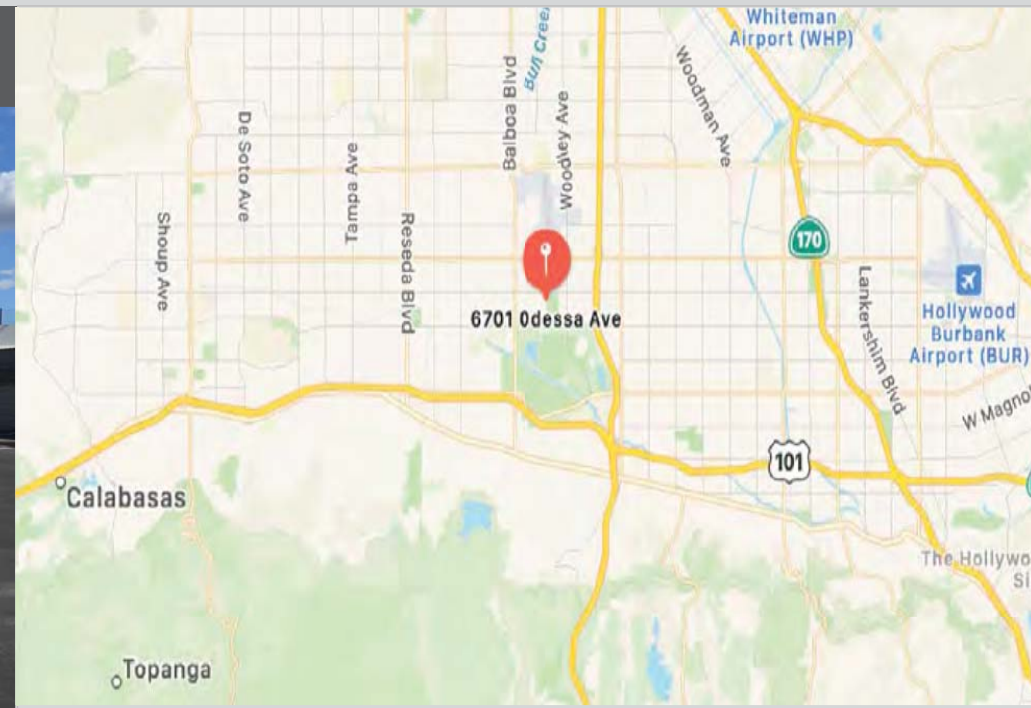

6701 Odessa Ave. Property Photos



6701 Odessa Ave. Property Photos



6701 Odessa Ave. Property Photos



6701 Odessa Ave. Property Photos



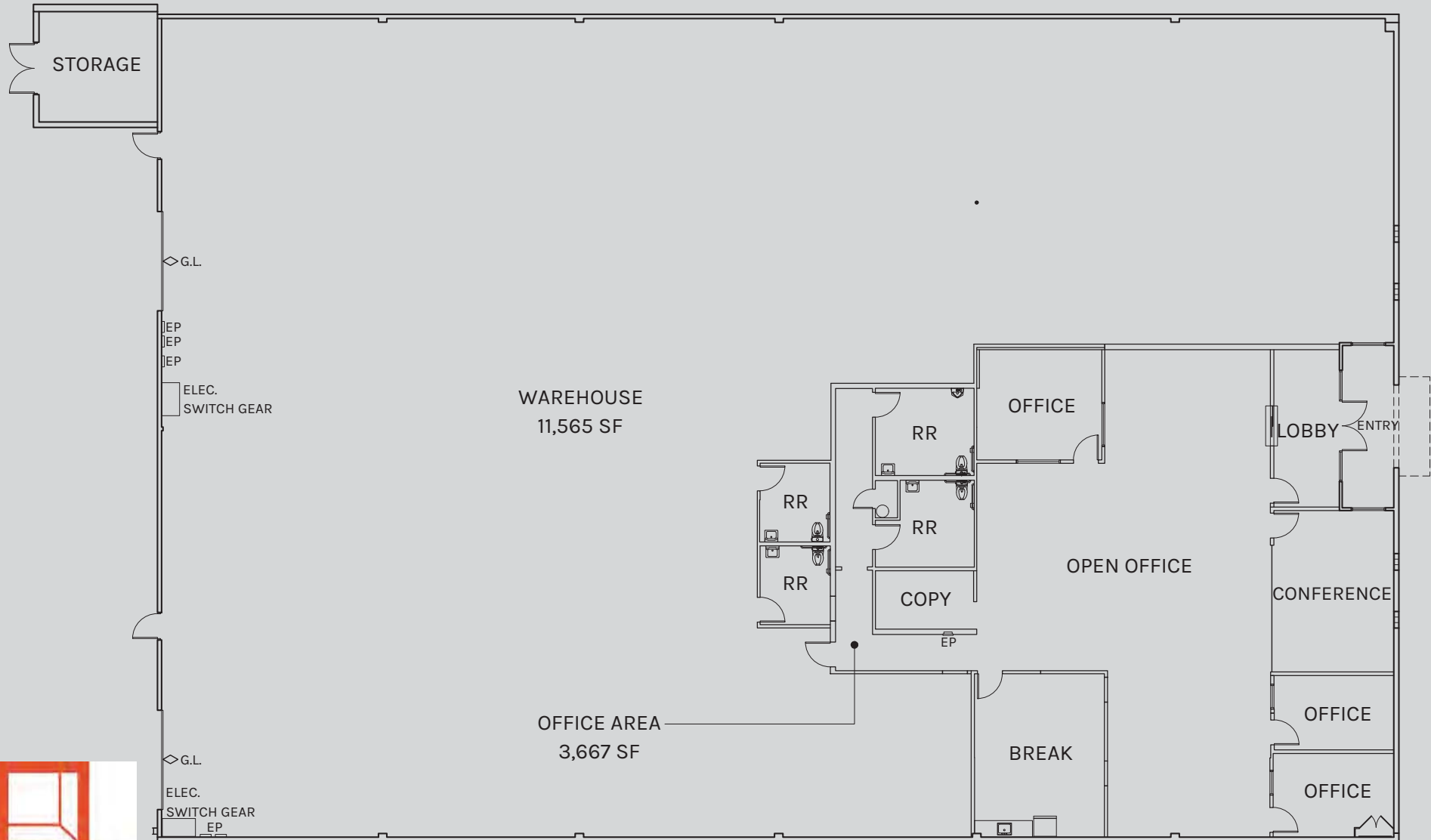

PLAN LAYOUT SUBJECT TO FIELD CONDITIONS AND MAY DIFFER FROM PLAN AS SHOWN. ALL INFORMATION PRESENTED ON THIS DRAWING IS PRESUMED TO BE ACCURATE, HOWEVER TENANT SHOULD VERIFY PERTINENT INFORMATION PRIOR TO COMMITTING TO A LEASE. ANY FURNITURE OR APPLIANCES SHOWN ON PLAN ARE FOR CONCEPT ONLY AND WILL BE TENANT PROVIDED.