

FOR LEASE

**PEAK**  
COMMERCIAL



# Grand Avenue Plaza - Covina, CA

930-950 N Grand Ave Covina CA 91724



**FEDER & ASSOCIATES**  
COMMERCIAL REAL ESTATE

N GRAND AVE

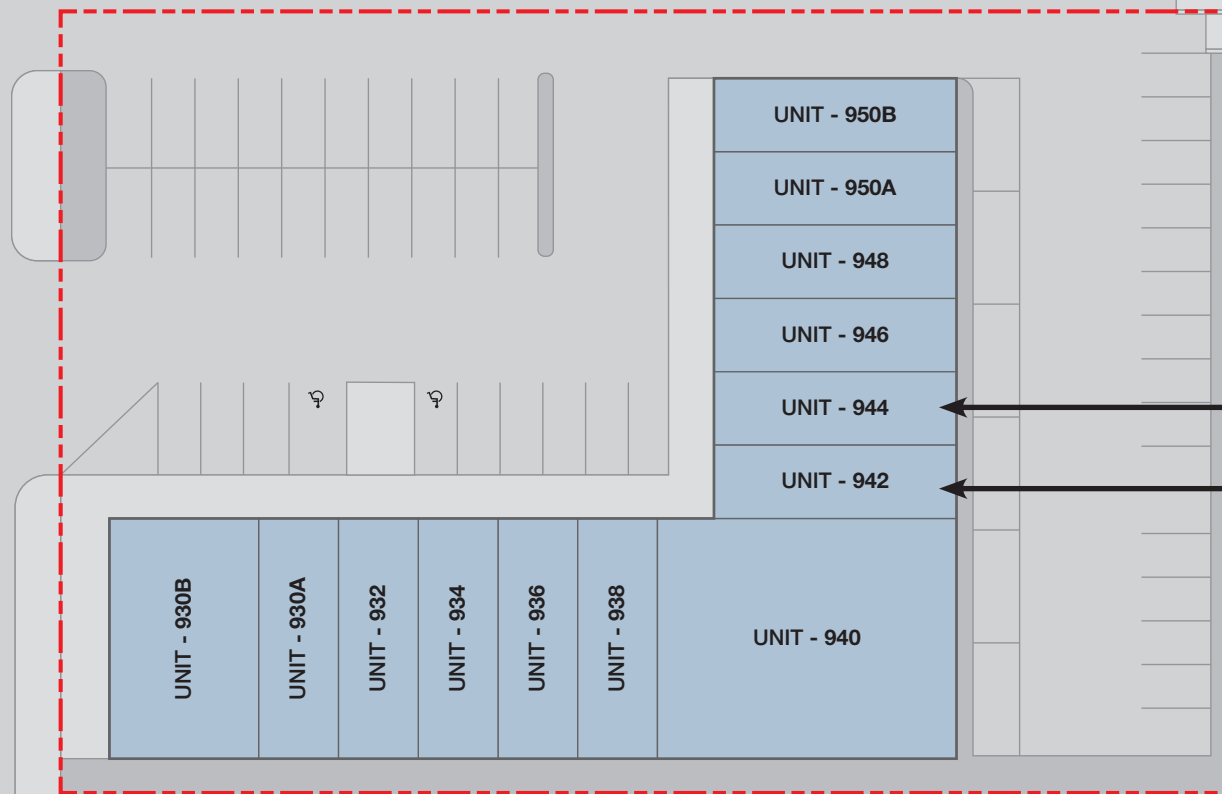

Available

## SUMMARY

PROPERTY	MULTI TENANT SHOPPING CENTER
ADDRESS	930-950, GRAND AVE, COVINA CA 91724
UNIT SIZE	+ /- 750 - 1,500 SQUARE FT
TYPE	RETAIL - OFFICE
RATE	INDIVIDUAL UNITS \$1.85 PSF (MG) BOTH UNITS \$1.75 PSF (MG)
CAM's	\$0.10 PSF (ESTIMATE)

## Exclusively Listed By:

RAMI MEHERABAN

Director

Peak Commercial - RJ Feder & Associates Team

D. 323.471.4747

E. RamiM@peakcommercial.com

CalBRE#01957846



# HIGHLIGHTS

- Located along Grand Ave. - one of Covina's main thoroughfares
- Efficient Unit sizes
- Units may be leased individually or leased as one space
- Well maintained center
- Great parking accommodations
- May be used for retail or office applications
- Low CAM's



**FEDER & ASSOCIATES**  
COMMERCIAL REAL ESTATE



THE INFORMATION PROVIDED HEREIN IS FROM SOURCES WE BELIEVE ARE RELIABLE. WHILE WE DO NOT DOUBT ITS ACCURACY, WE HAVE NOT VERIFIED IT AND MAKE NO REPRESENTATIONS, GUARANTEES OR WARRANTIES ABOUT IT.





THE INFORMATION PROVIDED HEREIN IS FROM SOURCES WE BELIEVE ARE RELIABLE. WHILE WE DO NOT DOUBT ITS ACCURACY, WE HAVE NOT VERIFIED IT AND MAKE NO REPRESENTATIONS, GUARANTEES OR WARRANTIES ABOUT IT.



**FEDER & ASSOCIATES**  
COMMERCIAL REAL ESTATE

For more information please contact:

RAMI MEHERABAN

Director

D. 323.471.4747

E. [RamiM@peakcommercial.com](mailto:RamiM@peakcommercial.com)

CalBRE#01957846

Peak Commercial does not guarantee the accuracy of square footage, lot size or other information concerning the condition or features of the property provided by the owner or obtained from public records or other sources the interested parties are advised to independently verify the accuracy of that information through personal inspection with appropriate licensed professionals.

Peak Commercial is proud to be part of the Peak Corporate Network

The Peak Corporate Network is a brand that represents a group of related separate legal entities, each providing its unique set of real estate services

5900 Canoga Ave., Suite 110, Woodland Hills, CA 91367 Office: 818-836-6717 Fax: 818-836-6718 CalBRE# 01985275

