



Available For Lease

\$25K BROKER BONUS FOR 5 YR TERM



±15,232 SF AVAILABLE FOR LEASE

6701 Odessa Avenue | Van Nuys, CA

WAREHOUSE DISTRIBUTION

PREMIERE CENTRAL VALLEY LOCATION | EXCEPTIONAL INDUSTRIAL OPPORTUNITY



**Rexford
Industrial**

PEAK
COMMERCIAL

FEATURES

- ±15,232 SF industrial building
- ±3,667 SF office
- ±16'-18' minimum clear height
- 2 ground level doors
- Available June 1, 2026
- **Lease Rate: \$1.69/SF NNN**
- NNN: \$0.26/SF
- Parking: 36 spaces
- Premiere Central Valley Location
- Power: 400-amp, 120-208v, single phase, 3 wire
- Perfect for assembly, light manufacturing, distribution or service center
- Institutionally owned & managed W/ flexibility to expand
- **\$25K Broker Bonus Thru 6/30/26 on a 5 Yr Term**

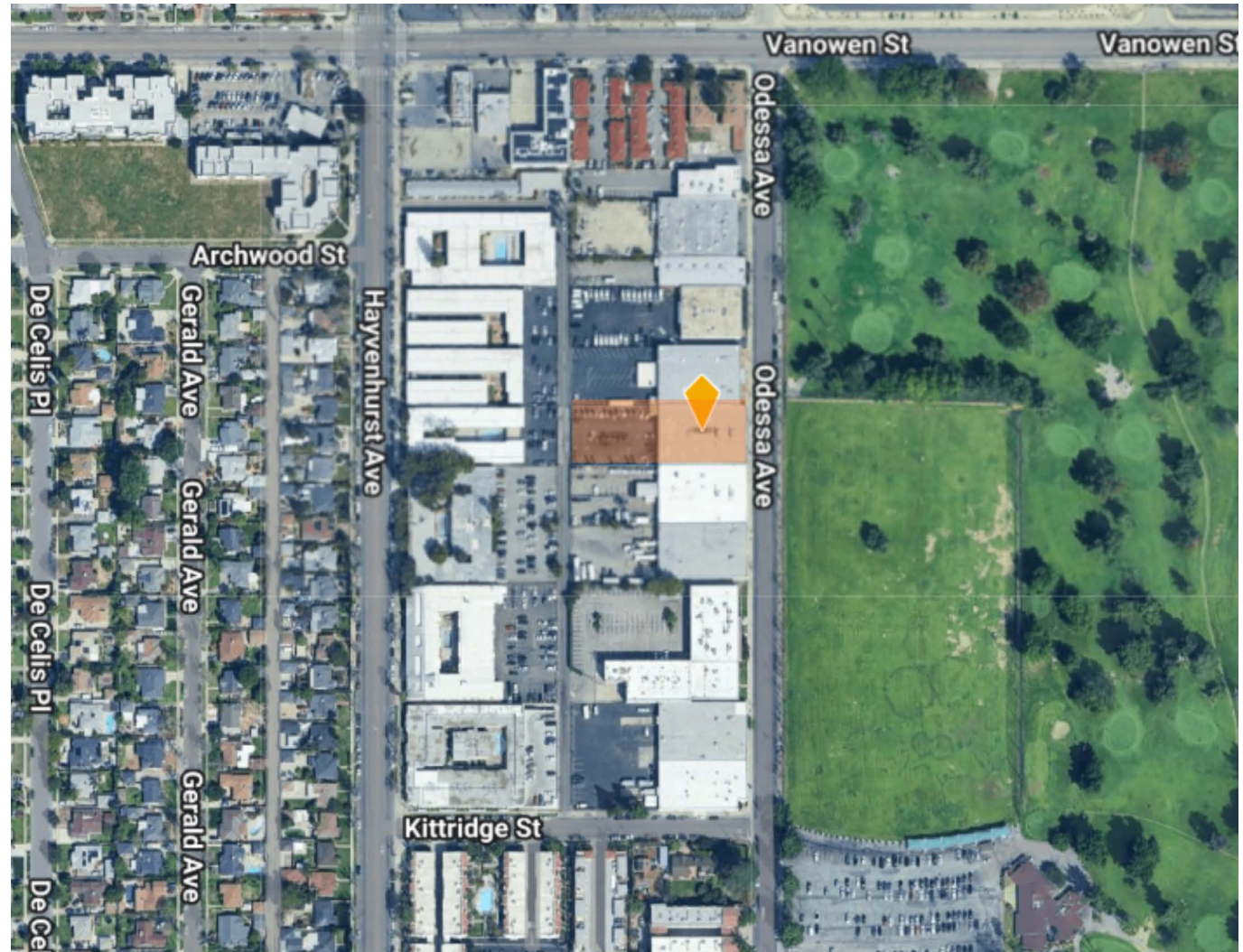





Exterior Photos

6701 Odessa Avenue



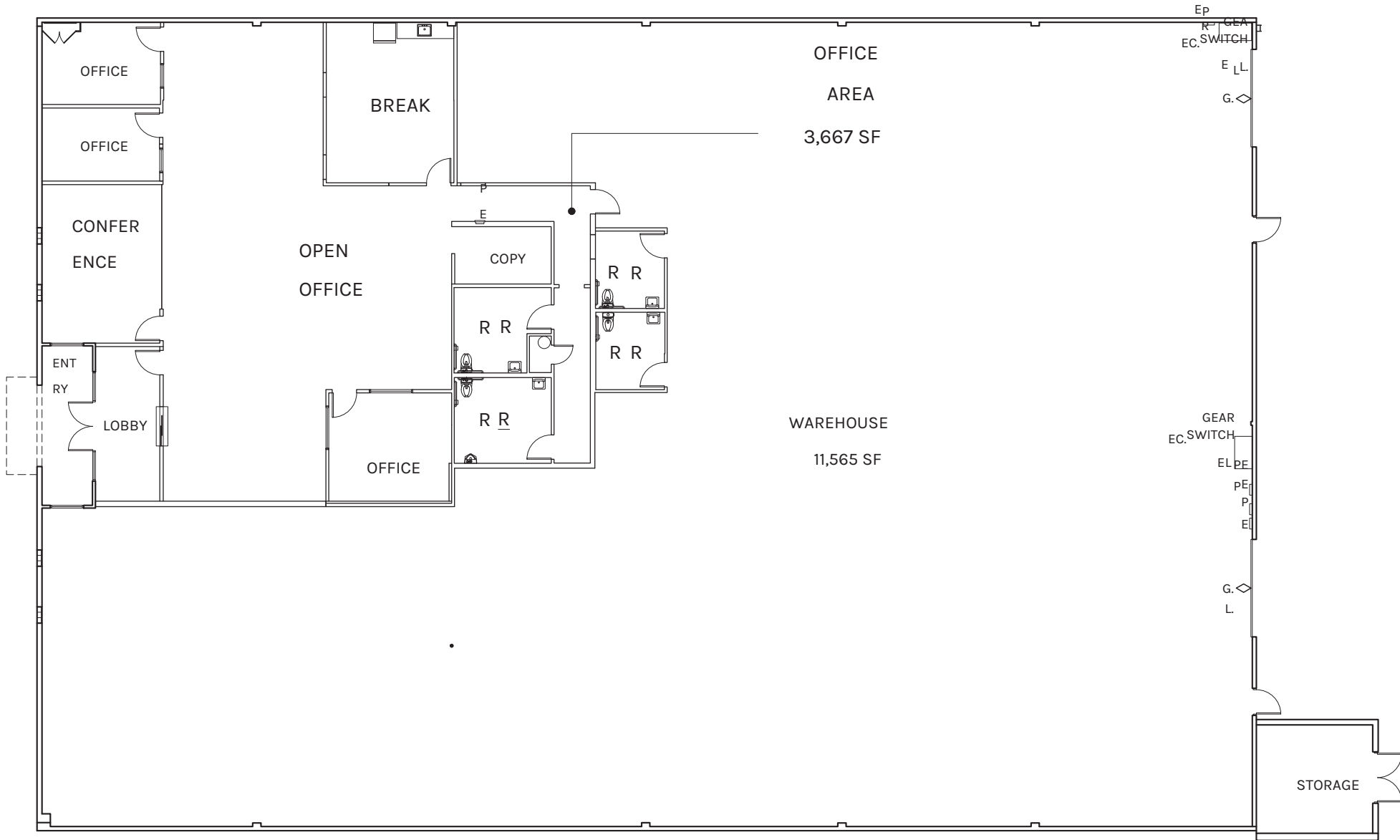

PLAN LAYOUT SUBJECT TO FIELD CONDITIONS AND MAY DIFFER FROM PLAN AS SHOWN. ALL INFORMATION PRESENTED ON THIS DRAWING IS PRESUMED TO BE ACCURATE, HOWEVER TENANT SHOULD VERIFY PERTINENT INFORMATION PRIOR TO COMMITTING TO A LEASE. ANY FURNITURE OR APPLIANCES SHOWN ON PLAN ARE FOR CONCEPT ONLY AND WILL BE TENANT PROVIDED.

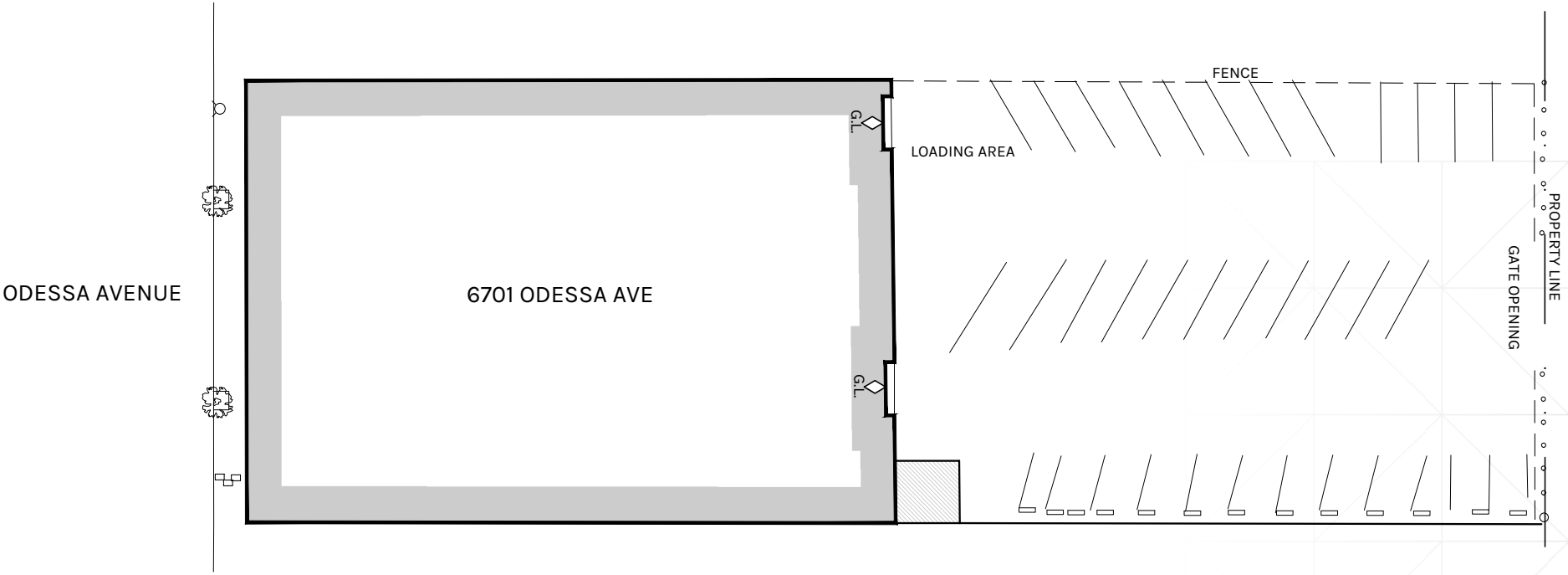

PLAN LAYOUT SUBJECT TO FIELD CONDITIONS AND MAY DIFFER FROM PLAN AS SHOWN. ALL INFORMATION PRESENTED ON THIS DRAWING IS PRESUMED TO BE ACCURATE, HOWEVER TENANT SHOULD VERIFY PERTINENT INFORMATION PRIOR TO COMMITTING TO A LEASE.

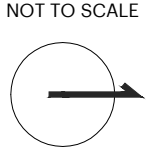

Amenities Map

6701 Odessa Avenue

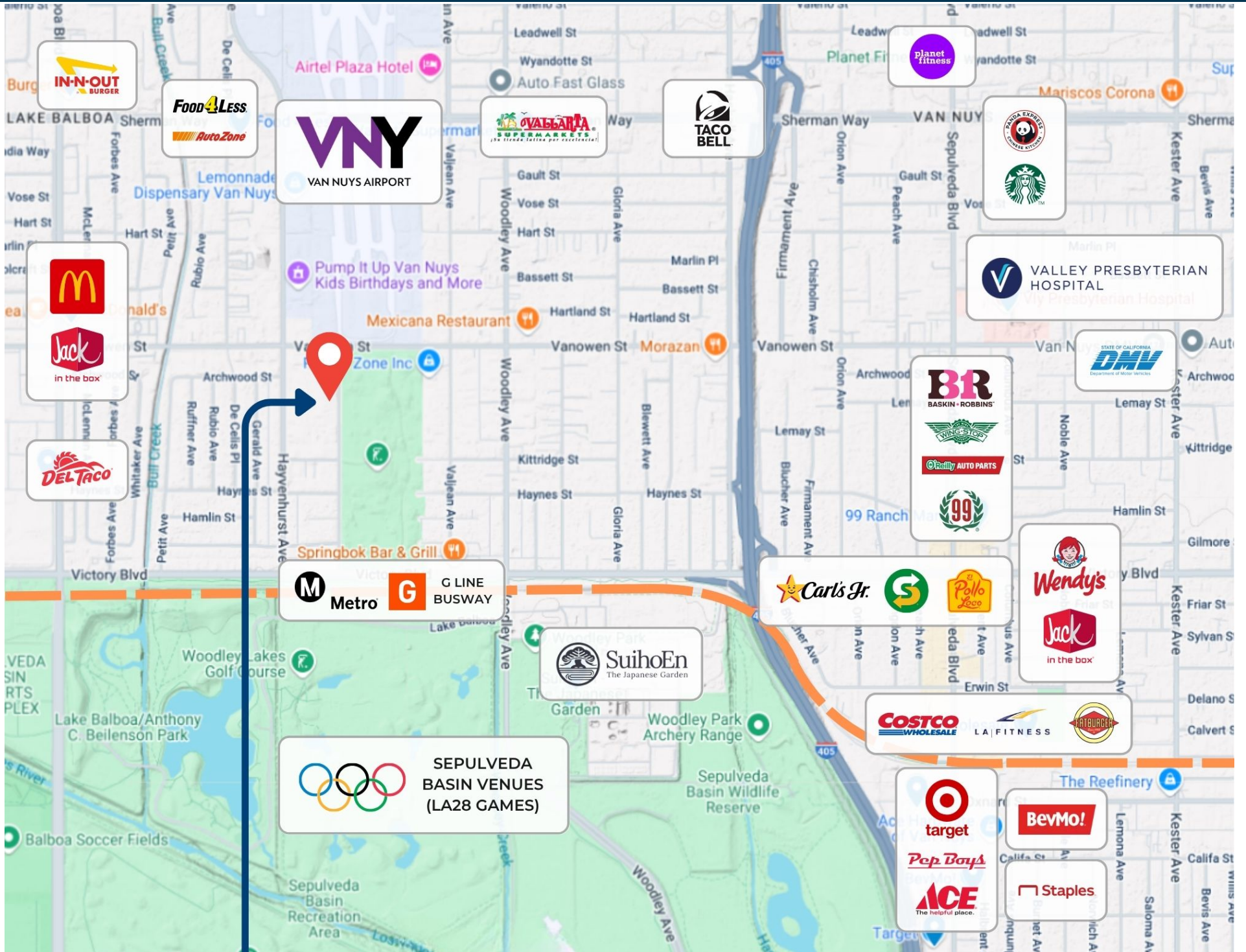



**Rexford
Industrial**

Leasing Contacts



RON FEDER

Senior Managing Director

O: 818.222.0404

rfeder@rjfeder.com

DRE# 00983855



JESSICA CHAMBERLAIN

Commercial Associate

O: 818.222.0404

jessica@rjfeder.com

DRE# 01898574



FEDER & ASSOCIATES
COMMERCIAL REAL ESTATE

PEAK COMMERCIAL

PEAK COMMERCIAL
www.peakcommercial.com