



Available For Lease

**\$25K BROKER BONUS FOR 5 YR TERM**



**±15,232 SF AVAILABLE FOR LEASE**

6701 Odessa Avenue | Van Nuys, CA

**WAREHOUSE DISTRIBUTION**

PREMIERE CENTRAL VALLEY LOCATION | EXCEPTIONAL INDUSTRIAL OPPORTUNITY



**Rexford  
Industrial**

**PEAK**  
COMMERCIAL

## FEATURES

- ±15,232 SF industrial building
- ±3,667 SF office
- ±16'-18' minimum clear height
- 2 ground level doors
- Available May 1, 2026
- **Lease Rate: \$1.69/SF NNN**
- NNN: \$0.26/SF
- Parking: 36 spaces
- Premiere Central Valley Location
- Power: 400-amp, 120-208v, single phase, 3 wire
- Perfect for assembly, light manufacturing, distribution or service center
- Institutionally owned & managed W/ flexibility to expand
- **\$25K Broker Bonus Thru 6/30/26 on a 5 Yr Term**

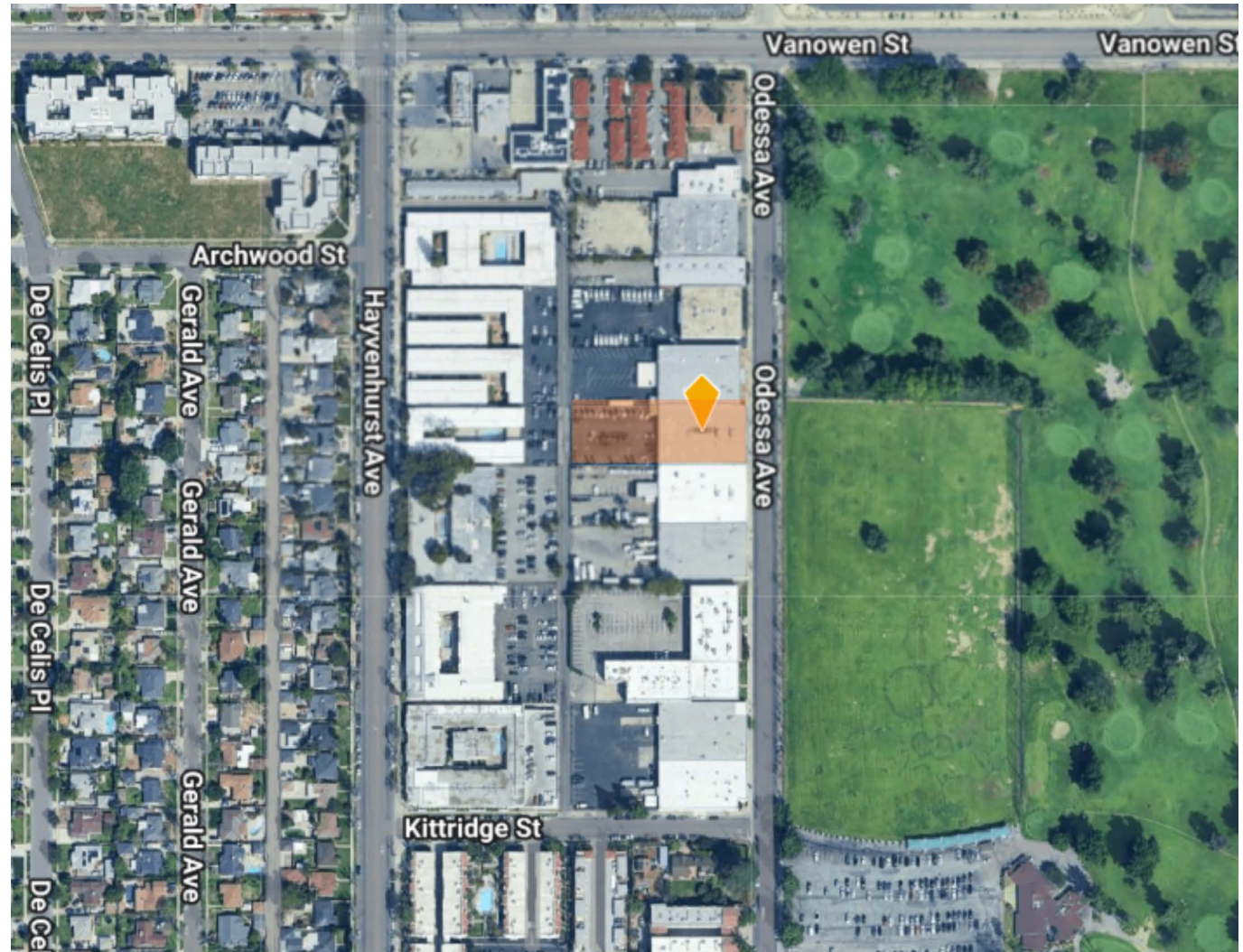





# Exterior Photos

6701 Odessa Avenue



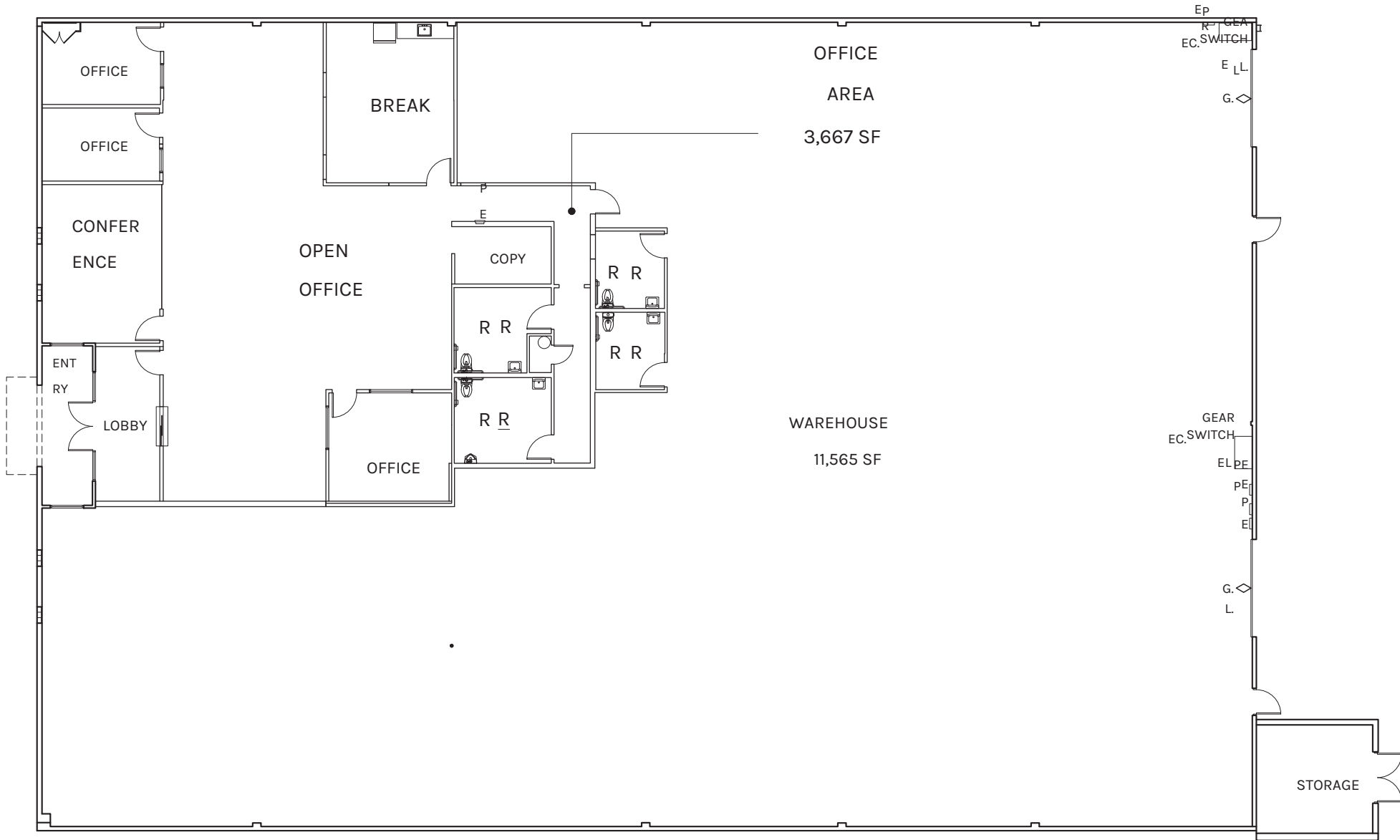

PLAN LAYOUT SUBJECT TO FIELD CONDITIONS AND MAY DIFFER FROM PLAN AS SHOWN. ALL INFORMATION PRESENTED ON THIS DRAWING IS PRESUMED TO BE ACCURATE, HOWEVER TENANT SHOULD VERIFY PERTINENT INFORMATION PRIOR TO COMMITTING TO A LEASE. ANY FURNITURE OR APPLIANCES SHOWN ON PLAN ARE FOR CONCEPT ONLY AND WILL BE TENANT PROVIDED.

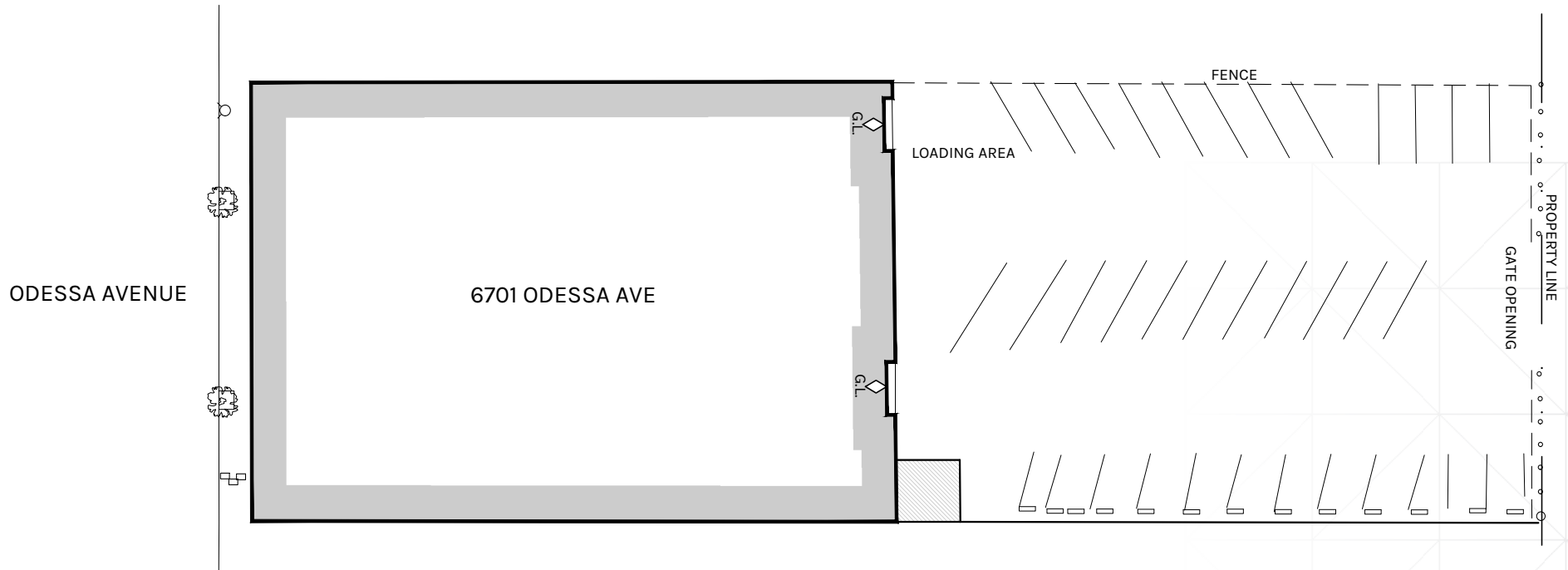

PLAN LAYOUT SUBJECT TO FIELD CONDITIONS AND MAY DIFFER FROM PLAN AS SHOWN. ALL INFORMATION PRESENTED ON THIS DRAWING IS PRESUMED TO BE ACCURATE, HOWEVER TENANT SHOULD VERIFY PERTINENT INFORMATION PRIOR TO COMMITTING TO A LEASE.

NOT TO SCALE

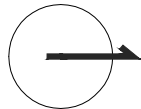

# Amenities Map

6701 Odessa Avenue

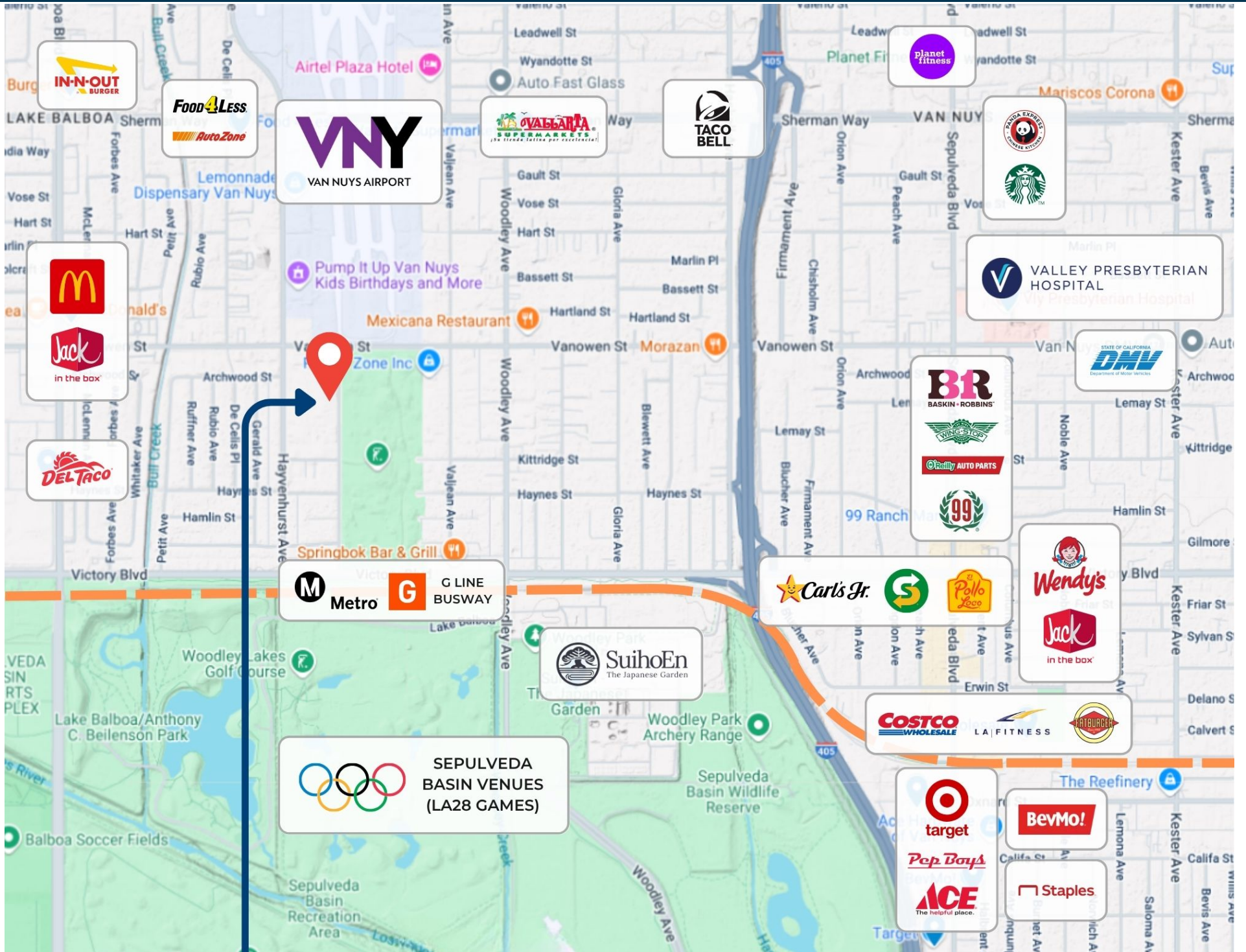



**Rexford  
Industrial**

## Leasing Contacts



**RON FEDER**

Senior Managing Director

O: 818.222.0404

[rfeder@rjfeder.com](mailto:rfeder@rjfeder.com)

DRE# 00983855



**JESSICA CHAMBERLAIN**

Commercial Associate

O: 818.222.0404

[jessica@rjfeder.com](mailto:jessica@rjfeder.com)

DRE# 01898574



FEDER & ASSOCIATES  
COMMERCIAL REAL ESTATE

**PEAK** COMMERCIAL

**PEAK COMMERCIAL**  
[www.peakcommercial.com](http://www.peakcommercial.com)